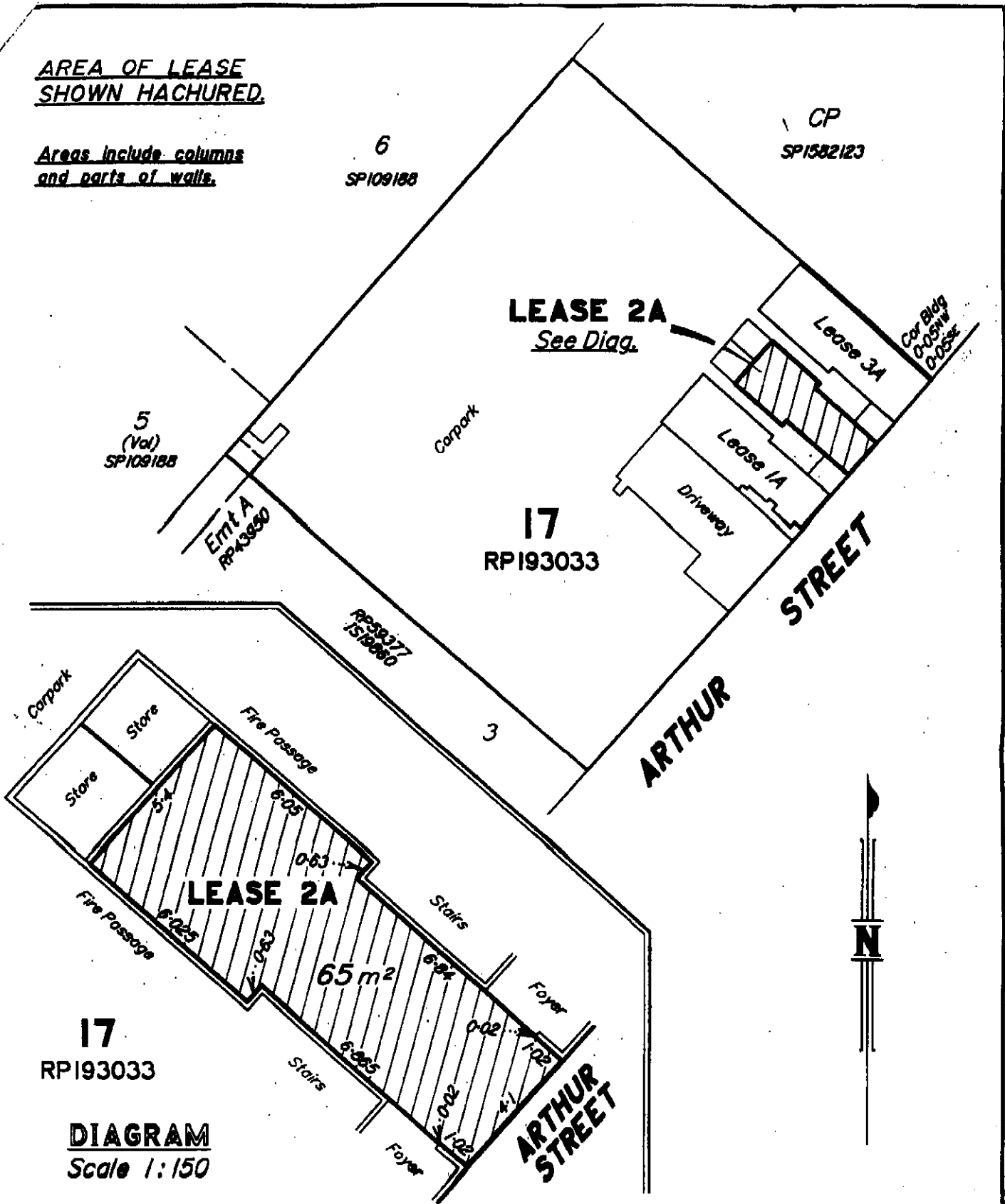




**AREA OF LEASE SHOWN HACHURED.**

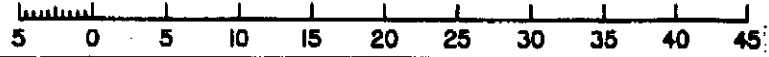
Areas include columns and parts of walls.



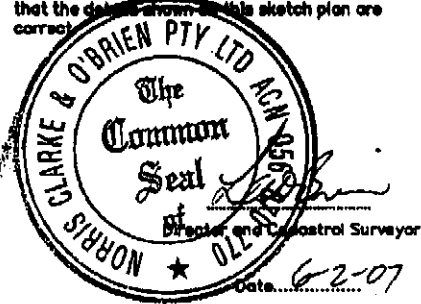
**17**  
RP193033

**DIAGRAM**  
Scale 1:150

Scale 1:500 - Lengths are in Metres.



NORRIS CLARKE & O'BRIEN PTY LTD Cadastral Surveyors, (ACN 056 870 770) hereby certify that the details shown on this sketch plan are correct.

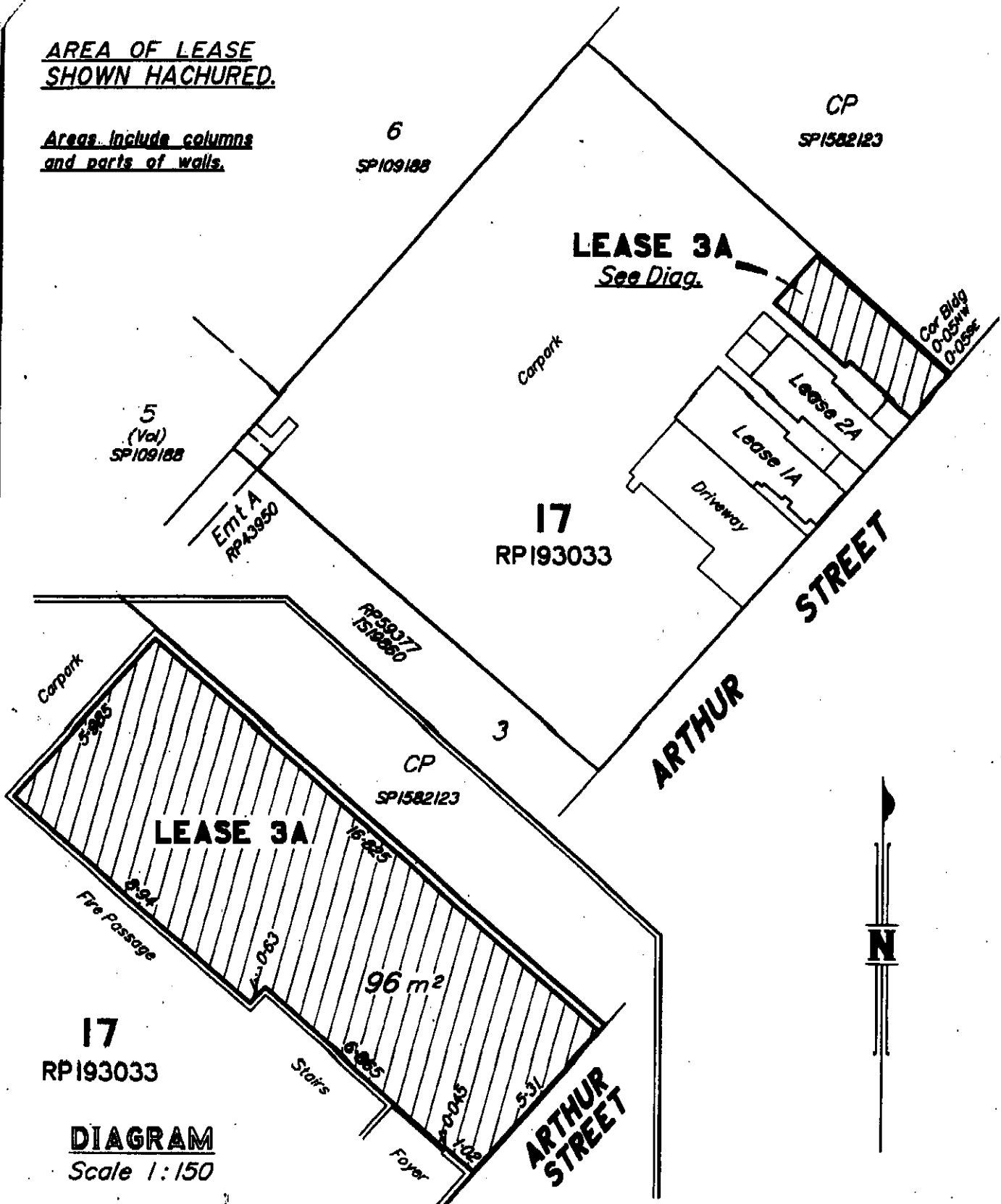


|  |                               |
|--|-------------------------------|
| "ACCREDITED SURVEYOR"  | "SKETCH OK" <i>KAS 6/2/07</i> |
| Description<br><b>LEASE 2A (Being part of the BASEMENT floor of a building) in LOT 17 on RP193033 Parish of NORTH BRISBANE County of Stanley</b> |                               |
| Scale in Metres<br><b>1:500 at A4</b>  |                               |

|  |                 |
|--|-----------------|
| Norris Clarke & O'Brien Pty Ltd<br>Licensed Surveyors<br>Town Planners<br>Development Consultants  |                 |
| Unit 2 - 107 Quay Street<br>Brisbane QLD 4000<br>ph: 3221 9649 fax: 3221 3391<br>email: ncosurv@powerup.com.au<br>ACN 056 870 770 ABN 15 056 870 770 |                 |
| Title Ref.   | <b>1654412</b>  |
| Date   | <b>29/01/07</b> |
| Ref.   | <b>7825L-2A</b> |

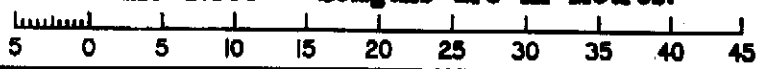
**AREA OF LEASE  
SHOWN HACHURED.**

**Areas include columns  
and parts of walls.**

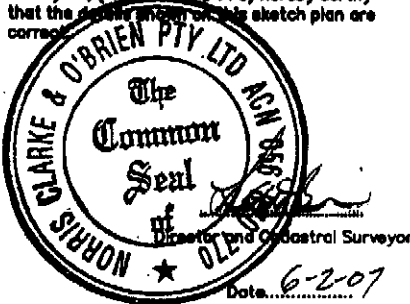


**DIAGRAM**  
Scale 1:150

Scale 1:500 - Lengths are in Metres.



NORRIS CLARKE & O'BRIEN PTY LTD Cadastral Surveyors, (ACN 056 870 770) hereby certify that the details shown on this sketch plan are correct.



|  |                             |  |
|--|-----------------------------|--|
| "ACCREDITED SURVEYOR"  | "SKETCH OK" <i>2007/2/7</i> | Norris Clarke & O'Brien Pty Ltd<br>Licensed Surveyors<br>Town Planners<br>Development Consultants  |
| Description<br><b>LEASE 3A (Being part of the BASEMENT floor of a building) in LOT 17 on RP193033 Parish of NORTH BRISBANE County of Stanley</b> |                             | Unit 2 - 107 Quay Street<br>Brisbane QLD 4000<br>ph: 3221 9649 fax: 3221 3391<br>email: ncosurv@powerup.com.au<br>ACN 056 870 770 ABN 15 056 870 770 |
| Scale in Metres.<br><b>1:500 at A4</b>   |                             | Title Ref.<br><b>1654412</b>   |
|  |                             | Date<br><b>29/01/07</b> Ref. <b>7825L-3A</b>   |