

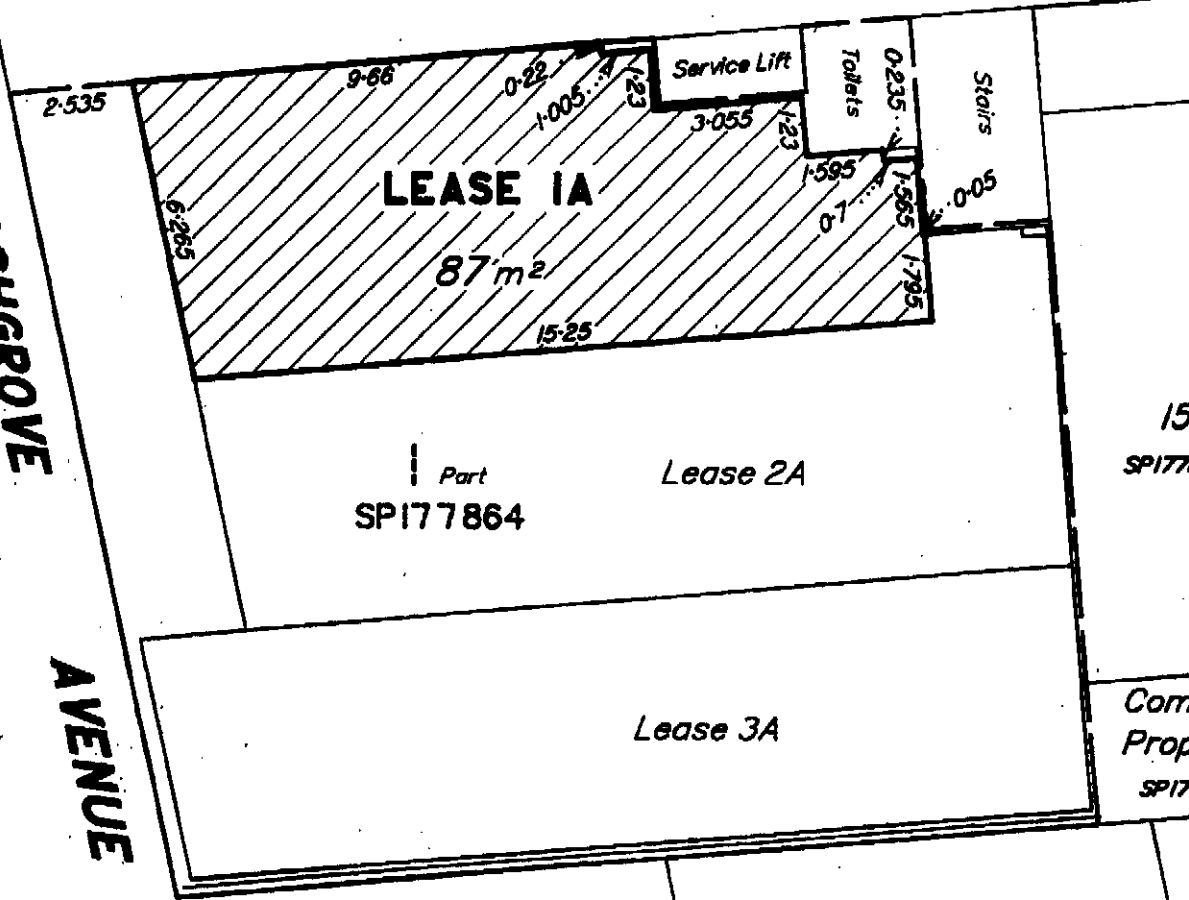

Common Property
SP177865

ASHGROVE AVENUE



Part
SP177864

Lease 2A

15
SP177865

Lease 3A

Common Property
SP177865

RP
15

31897

2

20488

3

AREA OF LEASE SHOWN HATCHURED.

Areas include columns and parts of walls.

NORRIS CLARKE & O'BRIEN PTY LTD Cadastral Surveyors, (ACN 056 870 770) hereby certify that the details shown on this sketch plan are correct.

Scale 1:150 - Lengths are in Metres

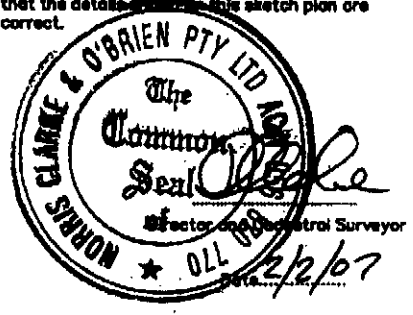
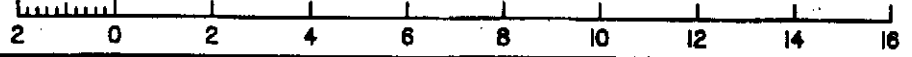

"ACCREDITED SURVEYOR"	"SKETCH OK" <i>OC</i>	Norris Clarke & O'Brien Pty Ltd Licensed Surveyors Town Planners Development Consultants Unit 2 - 107 Quay Street Brisbane QLD 4000 ph: 3221 9649 fax: 3221 3391 email: ncosurv@powerup.com.au ACN 056 870 770 ABN 15 056 870 770
Description LEASE IA (Being part of the GROUND floor of a building) in LOT 1 on SPI77864 Parish of ENOGGERA County of Stanley		
Scale in Metres 1:150 at A4		Title Ref. 29/01/07 Ref. 6999L-IA



Common
Property
SPI77865

ASHGROVE
AVENUE

14703
7046

Part
SPI77864

Lease 1A

Service Lift

Toilets

Stairs

0.2

2.0

1.785

0.5

15.25

LEASE 2A

95 m²

15
SPI77865

5.255

6.91

17.05

Lease 3A

Common
Property
SPI77865

2

3

20488

RP
15

31897

AREA OF LEASE
SHOWN HACHURED.

Areas include columns
and parts of walls.

Scale 1:150 - Lengths are in Metres



NORRIS CLARKE & O'BRIEN PTY LTD. Cadastral
Surveyors, (ACN 056 870 770) hereby certify
that the details shown on this sketch plan are
correct.

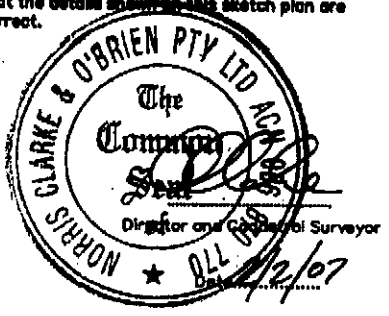

"ACCREDITED SURVEYOR"	"SKETCH OK"	Norris Clarke & O'Brien Pty Ltd Licensed Surveyors Town Planners Development Consultants Unit 2 - 107 Quay Street Brisbane QLD 4000 ph: 3221 8649 fax: 3221 3391 email: ncosurv@powerup.com.au ACN 056 870 770 ABN 15 056 870 770
Description LEASE 2A (Being part of the GROUND floor of a building) in LOT 1 on SPI77864 Parish of ENOGGERA County of Stanley		
Scale in Metres. 1:150 at A4		Title Ref. Date 29/01/07 Ref. 6999L-2A



Common Property
SP177865

Service Lift

Toilets

Stairs

Lease 1A

ASHGROVE

AVENUE

Part
SP177864

Lease 2A

15
SP177865

LEASE 3A

96 m²

Common Property
SP177865

19-25

19-605

5-08

5-08

SP177864
0-47

2

3

20488

RP
15

31897

AREA OF LEASE
SHOWN HACHURED.

Areas include columns
and parts of walls.

Scale 1:150 - Lengths are in Metres



NORRIS CLARKE & O'BRIEN PTY LTD Cadastral Surveyors, (ACN 056 870 770) hereby certify that the details shown on this sketch plan are correct.

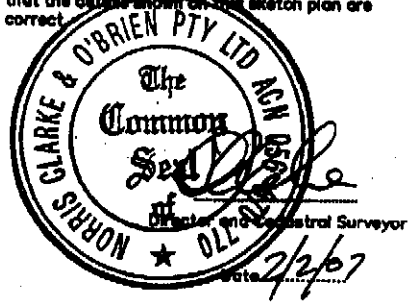

"ACCREDITED SURVEYOR"	"SKETCH OK"	Norris Clarke & O'Brien Pty Ltd Licensed Surveyors Town Planners Development Consultants Unit 2 - 107 Quay Street Brisbane QLD 4000 ph: 3221 9649 fax: 3221 3391 email: ncosurv@powerup.com.au ACN 056 870 770 ABN 15 056 870 770
Description: LEASE 3A (Being part of the GROUND floor of a building) in LOT 1 on SP177864 Parish of ENOGGERA County of Stanley		
Title Ref. Date 29/01/07 Ref. 6999L-3A		

Scale in Metres. 1:150 at A4