

NORRIS CLARKE & O'BRIEN PTY LTD Cadastral Surveyors, (ACN 056 870 770) hereby certify that the details shown on this sketch plan are correct.

Scale 1:150 - Lengths are in Metres

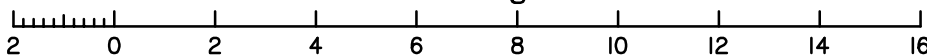

.....
Director and Cadastral Surveyor

Date.....

"ACCREDITED SURVEYOR"	"SKETCH OK"	Norris Clarke & O'Brien Pty Ltd NCB Licensed Surveyors Town Planners Development Consultants Unit 2 - 107 Quay Street Brisbane QLD 4000 ph: 3221 9649 fax: 3221 3391 email: ncosurv@powerup.com.au ACN 056 870 770 ABN 15 056 870 770
Description LICENCE AREA I (Being part of the LAND adjoining a building) in LOT 1 on SPI77864 Parish of ENOGGERA County of Stanley		
Title Ref.		Date 29/01/07 Ref. 6999LIC-1
Scale in Metres. 1:150 at A4		

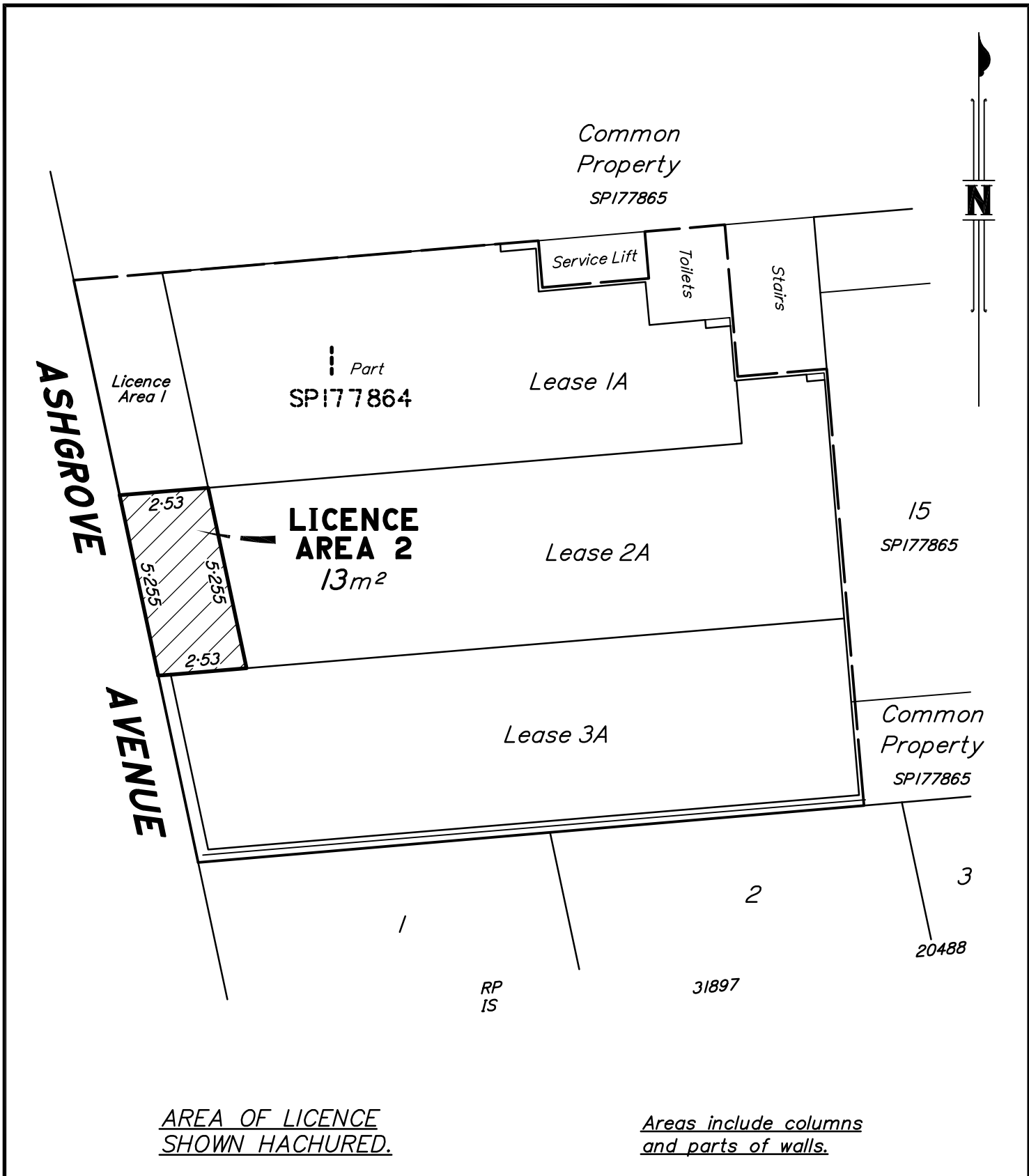

NORRIS CLARKE & O'BRIEN PTY LTD Cadastral Surveyors, (ACN 056 870 770) hereby certify that the details shown on this sketch plan are correct.

Scale 1:150 - Lengths are in Metres

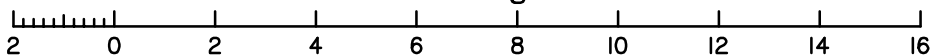

.....
Director and Cadastral Surveyor

Date.....

"ACCREDITED SURVEYOR"	"SKETCH OK"	Norris Clarke & O'Brien Pty Ltd NCB Licensed Surveyors Town Planners Development Consultants Unit 2 - 107 Quay Street Brisbane QLD 4000 ph: 3221 9649 fax: 3221 3391 email: ncosurv@powerup.com.au ACN 056 870 770 ABN 15 056 870 770
Description LICENCE AREA 2 (Being part of the LAND adjoining a building) in LOT 1 on SPI77864 Parish of ENOGGERA County of Stanley		
Title Ref.		Date 29/01/07 Ref. 6999LIC-2
Scale in Metres. 1:150 at A4		